

the **Lights**
andover



The Lights Technical Guide – October 2011

The Lights, West Street, Andover, Hampshire SP10 1AH
Tel: 01264 368368 www.thelights.org.uk Fax: 01264 338719

music theatre comedy dance education conferencing

Welcome to the Lights Technical Guide

The Lights has 2 performance areas, the Auditorium and the Arena, both with their own stage, lights and sound equipment.

On the following pages you'll find a wealth of information on the Lights, how to get here, where to park and unload, access and get ins as well as most of the technical information that you might require.



Should you not find the information you're seeking please contact us on:

Paul Reynolds	Technical Officer	01264 368828	preynolds@testvalley.gov.uk
Heather Whittam	Venue Director	01264 368814	hwhittam@testvalley.gov.uk
Rob Sewell	Operations Manager	01264 368835	rsewell@testvalley.gov.uk



Index

- 1 Cover page with address details
- 2 Introduction, Contact Details and Index
- 3 Directions and Parking
- 4 The Lights Plan view
- 5 Auditorium Specifications
- 6 Auditorium and Stage Plan view
- 7 Auditorium and Stage cross section
- 8 Arena Specifications
- 9 Arena and Stage Plan view

Directions and Parking

By Foot

The Lights is situated a two minute walk from the main town centre or a ten minute walk from Andover Rail station.

By Road to Andover

As the main route from London to the West Country and from Southampton to Oxford and the north, Andover is particularly easy to get to, and is situated just off the A303 and within easy reach of the M3 and M4.

Road signage to Stage Door

Please note that town centre road signage to The Lights directs visitors to the Chantry Centre car park.

To get to the Stage Door drive down Western Avenue and then turn into Chantry Street. This is a 1 way street and the road divides after roughly 100m. Follow the road to the left and just after the traffic island there is a tree-lined lane. Drive down this lane and at the end bear left and the Theatre is ahead of you. The Stage Door is on the right hand side of the Theatre. To gain access ring the white doorbell on the right-hand side of the Stage Door.

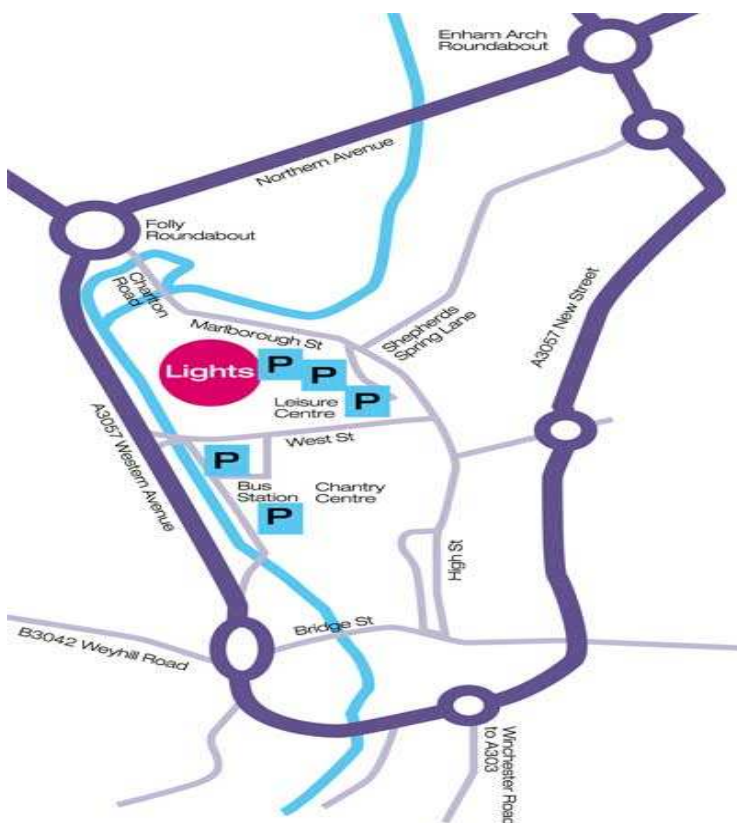

Public Parking around the Theatre

There are five public parking areas within 400 metres of The Lights.

The Chantry Centre multi-storey - free parking after 4pm but it **CLOSES** at 10pm

Marlborough Street - free parking after 4pm

Lidl (opposite Bus Station) - free parking after 6pm

AMC Building (adjacent to the Leisure Centre) - weekends only

Andover College - parking available.

£2 charge to exit the barrier.

By Rail to Andover

Andover is conveniently situated on the main London Waterloo to Exeter railway line.

Disabled Parking

There are 6, non-reserveable bays for disabled drivers, roughly 50 metres from the Theatre. To park in a disabled bay follow the Stage Door directions.

If you're having trouble locating us or can't find the Stage Door please call us and we'll direct you.

Accommodation in Andover

If you would like to stay overnight in Andover we have a local accommodation list at this link:
http://www.thelights.org.uk/visiting_us/access_facilities.aspx

The Lights Plan view

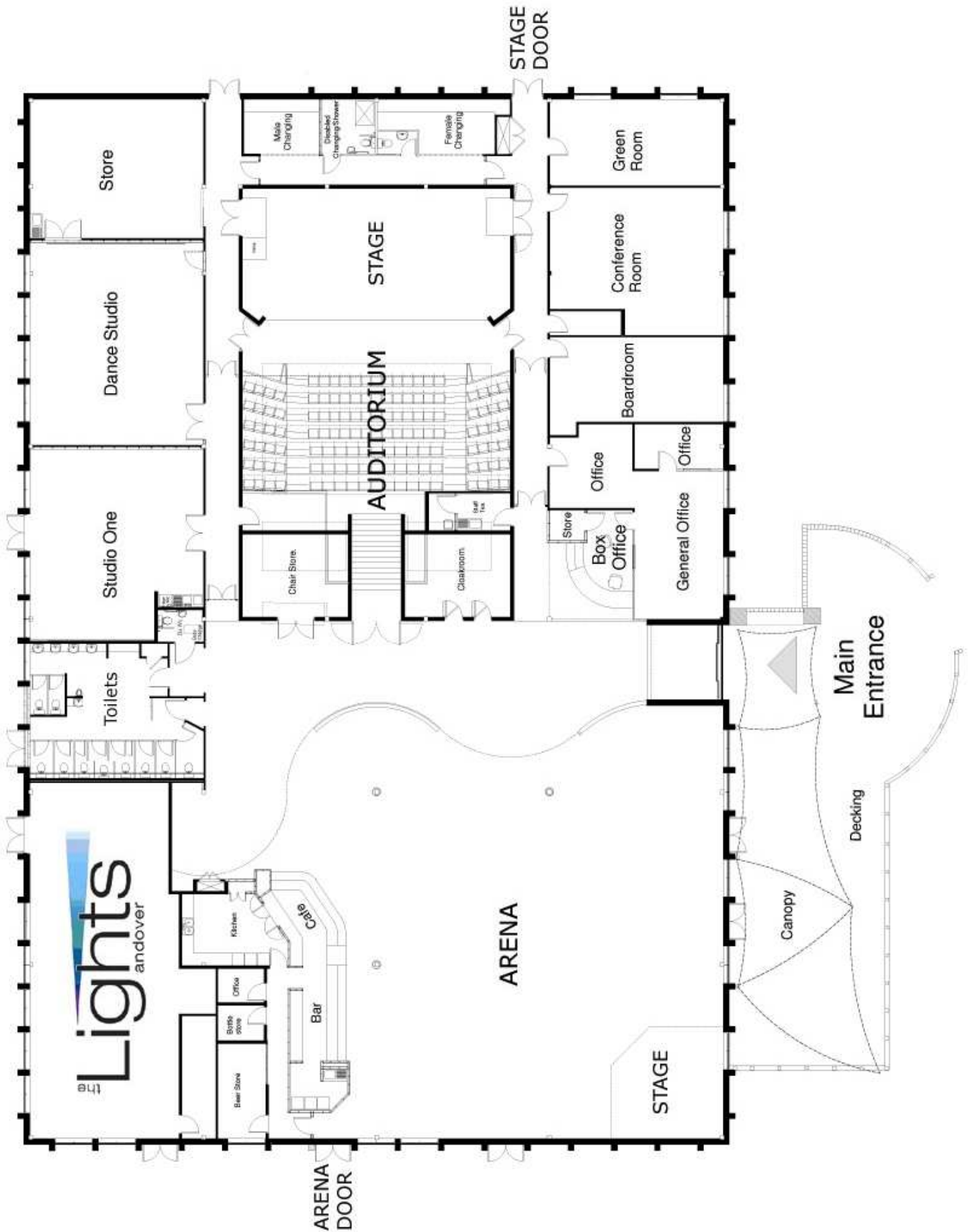

Auditorium Specifications

The Auditorium is in the centre of the building and can be accessed via 3 sets of double doors (Main Entrance, Audience Left & Right). There are 2 dressing and a Green Room behind the Stage.

Stage

The Stage is accessed via the Stage Door (at ground level) and a set of acoustic double doors which are each 2m high 1.5m wide. The stage itself is 13m wide (internal walls), 6m deep & 0.18m high. The fixed lighting grid is 6.4m from the surface of the stage. There is also a 6m x 4m projection screen. The back wall is white and has black tabs directly in front of it. There are 2 further sets of black tabs and 3 sets of black legs. The blue house tabs are hand winched from stage right. Power on stage is 1 off 63amp 10+N+E and also 1 off 63amp 30+N+E.

Seating

The Auditorium seats 242 (of which 33 are 'Pullman' style larger seats). There is ground floor access for up to 8 wheelchair users. The seating is fixed and single rake and there is no orchestra pit. The Control Box is situated to the rear of the Auditorium.

Lighting

The static rig can be configured to suit most performances but should you require an unusual lighting set-up please inform us well in advance of arrival.

Dimming:	48 Channels of Dimming (Chilli Pro 24-10i) 2 x 6 way Zero 33 Beta pack
Lighting Desk:	ETC Express
Lanterns:	8 x CCT Sil 15 - (1kw zoom profile) 12 x Strand Patt 743 - (1kw Fresnel) 4 x Strand Harmony PC - (1kw Prism-Convex) 24 x Par 64 - (1kw Par Can) 3 x Strand S-Type - (3 Colour Batten Flood) 10 x CCT Freedom Profiles 8 x CCT Freedom PCs 8 x CCT 500w Floods 8 x Source 4 Zooms 6 x Source 4 Junior 1 x Mirror Ball

NB: There are no follow spots

Sound

The Lights was one of the first theatres in the UK to install an Installation Line Array (ILA) giving superb sound within the entire Auditorium, whilst ensuring that the same quality of audio is heard throughout.

Sound Desk:	Allen & Heath GL2400-32
Amplifiers:	4 x QSC RMX 2450 2 x QSC RMX 5050
Digital Signal Processor:	1 x QSC 322ua Processor
Speakers:	10 x QSC WL2082-i line array modules 2 x QSC WL115-sw line array subs
Monitors:	4 x Studio Spares 15" Wedges
Tie-lines:	2 x 12+4 tie-line boxes
CD Player:	1 x Numark MP-102 1 x Numark CDN 22
Mini-Disc Player:	1 x Tascam MD350
Microphones and stands:	8 x Shure SM58 microphones 4 x Shure Beta 57 7 x Various Instrument microphones 5 x Tall stands 5 x Short stands
Radio Microphone:	2 x Sennheiser G2 radio mic package
Comms:	1 x Tech Pro Master Station 4 x Belt Pack & Headsets



Auditorium and Stage Plan View

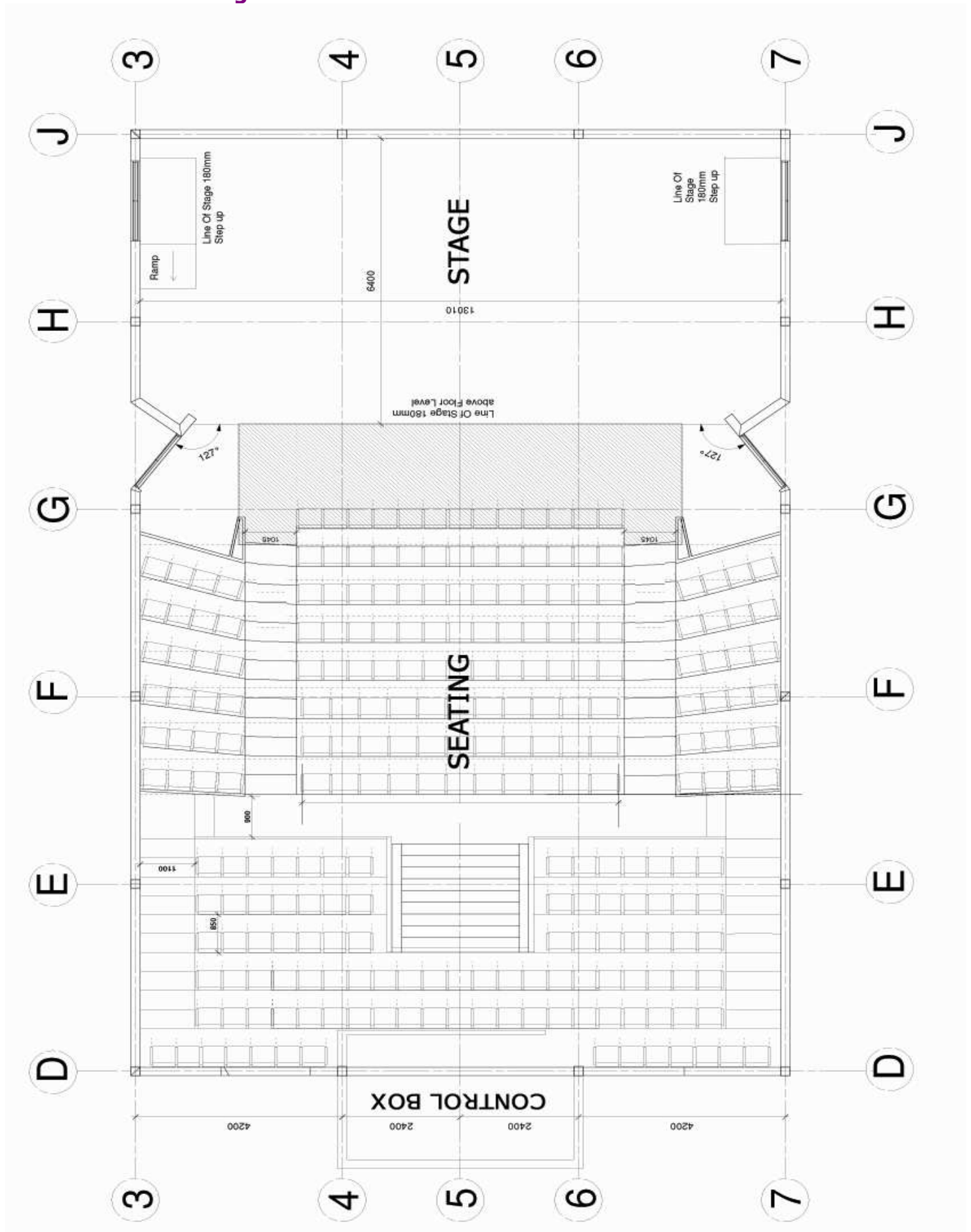

Auditorium and Stage Cross Section

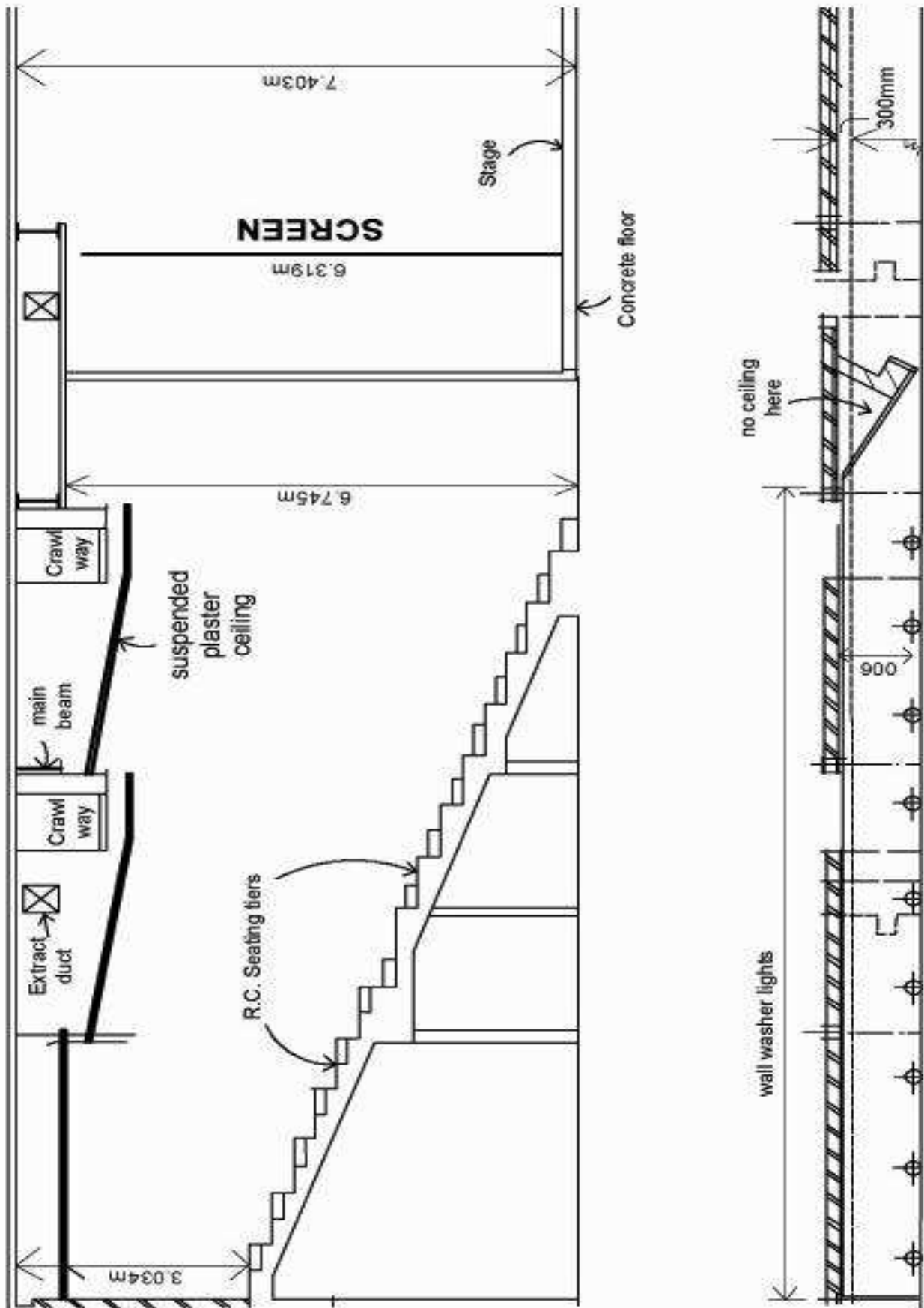

Arena Specifications

The Arena is a newly-created large area within The Lights, 18m x 20m (360m²) with a ceiling height of 3.5m.

It's perfect for large events, comedy or performances in the round, themed exhibitions, or when the lights are changed, a place to relax in a more intimate, cabaret style environment.

The Arena also contains the Bar and the Cafe, as well as an 8m square Pyramidal roof light. 2 sets of French doors and full length windows run along the south facing side, exiting directly onto the decking area (175m squared), which is covered by a large canopy. Adjacent to the Arena is the Box Office, Cloakroom and Toilets. The floor is blue carpet, with a vinyl surface under the pyramid. The Arena is a function space for 150-200 seated and roughly 350-500 standing but can be configured to suit your requirements. To separate the Arena from the foyer a 'moving' wall was created allowing for more privacy for private functions.

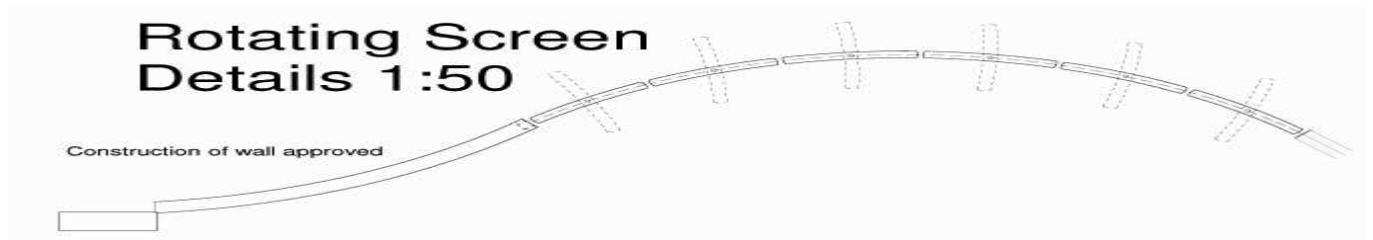

The Get-in is via double doors 5m from the stage at ground level, with nearby parking.

Stage

The Stage is 5m wide x 5m deep x 0.5m high, with steps (which are portable). There is a selection of 13 amp and a 63 amp socket (30+N) on the Stage.

Seating

In the Arena seating is comprised of 50 modular chairs and tables which can be arranged to suit your event, or removed totally to allow more space.

Lighting

There is a 6m Internally Wired Bar in front of the Stage with 10 500w Par Cans. Behind the stage and around the Arena are 8 Led wall washers as well as dimmable house lights. The Pyramid also has perimeter lighting.

Sound

There are 2 sources of audio in the Arena, a background music system and the main stage system.

Sound Desk:	Soundcraft 24/32 LX-7ii desk
Amplifiers:	2 x QSC RMX 1850 2 x QSC RMX 2450
Digital Signal Processor:	1 x BSS 3088LL Processor
Speakers:	2 x JBL JRX125 1 x JBL JRX118 6 x JBL Control 28's infil speakers.
Monitors:	3 x JBL EON 1500 speakers
CD Player:	1 x Numark CDN 22
Microphones and stands:	8 x Shure SM58 microphones 7 x Various Instrument mics 5 x Tall stands 5 x Short stands
Radio Microphone:	2 x Sennheiser G2 radio mic package



Arena and Stage Plan View

The Arena measures 18m from the Bar to the Stage wall and 20m across.

